



NTC THERMISTORS: TYPE JC

CLIP-ON PIPE SENSOR

DESCRIPTION:

A range of temperature sensing elements on a ceramic / metal shoe assembly and held in a polymer housing and provided with connector tabs. The housing is fitted with a spring metal clip for pipe attachment. A water resistant version is also available, incorporating a foam seal and sealed wire outlet holes. The elements available are NTC, PTC, SLN (silicon linear PTC) and PRT (Pt).



FEATURES:

- Fast time response (1.5s typical)
- Low temperature gradient (<1°C at 60°C)
- Sensing element electrically isolated from shoe (isolation >2MΩ at 500V)
- Water resistant version meets IP44 standard (with connector tabs encapsulated)
- Range of clips for pipe diameters 13 to 30mm
- Self-adjusts to irregular pipes
- Offers cost benefits over traditional immersion probes
- Typical applications include gas boiler control, domestic water systems, air conditioners, radiator inlet-outlet, electric showers, vending machines

GENERAL DATA:

Minimum operating temperature 0°C
Maximum temperature 100°C (sensor)
 85°C (housing)
Dissipation factor ≥2mW/K
 (mounted on copper pipe at 25°C)
Isolation voltage 500V d.c.
Clip force:
 <50N for mounting / de-mounting on pipe
 5N will not cause rotation on pipe
Shoe material Plated brass
Body material Nylon
Pack quantity & MOQ 200 pcs

DIMENSIONS:

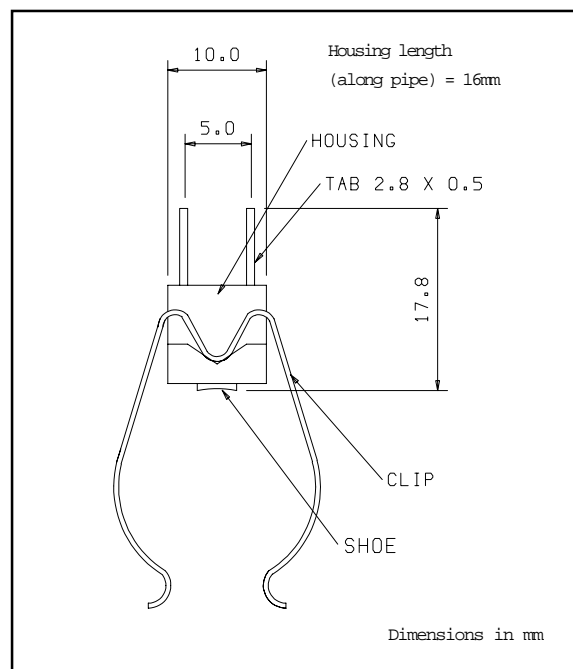

Sensor type	Response time (seconds)
NTC	≤1.8 (to 90% voltage change)
PTC	≤2 (to T _{NF} + 5°C - sensor applied to pipe at T _{NF} + 23°C)
SLN	≤3 (to 63.2% temperature change)
PRT	≤3 (to 63.2% temperature change)

OPTIONS:

- Other resistance - temperature characteristics
- Special pipe sizes
- Waterproof version - JW (see separate data sheet)

Data sheet D-JC-3

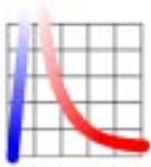

NTC THERMISTORS: TYPE JC

CLIP-ON PIPE SENSOR

NTC DATA:

For codes see below.

Code	Nominal resistance			Tolerances						B 25/85 K	Identification colour dot
	25°C	60°C	85°C	25°C		60°C		85°C			
	Ω	Ω	Ω	±%	±°C	±%	±°C	±%	±°C		
JC502C3R5/X	4990	1250	540	6.46	1.48	5.00	1.40	5.90	1.87	3960 ± 1%	Orange
JC103C3R5/X	9983	2500	1079	6.46	1.48	5.00	1.40	5.90	1.87	3960 ± 1%	None
JC103C4R5/X	9925	3000	1441	6.26	1.67	5.00	1.60	5.77	2.09	3435 ± 1%	Yellow

PTC DATA:

Maximum applied voltage 30V

Maximum applied voltage for temperature sensing 2.5V

For codes see below.

	T _{NF}	-20 to T _{NF} - 20°C		25°C		T _{NF} - 5°C		T _{NF} + 5°C		T _{NF} + 23°C		Identification Dots
		Ω	V d.c.	Ω	V d.c.	Ω	V d.c.	Ω	V d.c.	Ω	V d.c.	
JC 060 X	60°C	<=250	2.5	<=100	0.2	<=570	2.5	>=570	2.5	>=10000	2.5	White/Grey
JC 070 X	70°C	<=250	2.5	<=100	0.2	<=570	2.5	>=570	2.5	>=10000	2.5	White/Brown
JC 080 X	80°C	<=250	2.5	<=100	0.2	<=570	2.5	>=570	2.5	>=10000	2.5	White/White

SILISTOR DATA:

Code JC202SLN1/X

Measurements made at 1mA

	25°C	60°C	85°C
Resistance Ω	1980 - 2020	2577.1 - 2641.3	3024.2 - 3146.5
Temperature Deviation	±1.27°C	±2.28°C	±3.0°C

For resistances at other temperatures use:

$$R_T = R_{25} (1 + \alpha (T-25) + \beta (T-25)^2)$$

Where: $\alpha = 7.88 \cdot 10^{-3} \text{ K}^{-1}$; $\beta = 1.937 \cdot 10^{-5} \text{ K}^{-2}$ and T°C

PRT DATA:

Tolerance Class A

Code JC102PRTA/X

Refer to separate tables for RvT

	0	25	60	85
Resistance Ω	1000	1097	1232	1328
Temperature Deviation °C	0.15	0.2	0.27	0.32

CODING FOR PIPE SIZE:

Clip size is specified by replacing X in the codes above as shown in the table on the right. To specify water-resistant version, add suffix M:

e.g. JC502C3R5/17M.

X	Pipe diameter range mm
13	13 - 15
17	17 - 18.5
20	20 - 22
28	28 - 30

Data sheet D-JC-3

THERMOMETRICS UK
 Crown Industrial Estate, Priorswood Rd
 Taunton, Somerset TA2 8QY UK
 Tel +44 (0)1823 335200
 Fax +44 (0)1823 332637
 Email: info@thermometrics.com

THERMOMETRICS NEW JERSEY
 808 US Highway 1
 Edison, New Jersey 08817-4695 USA
 Tel +1 (732) 287 2870
 Fax +1 (732) 287 8847
 Email: sales@thermometrics.com

THERMOMETRICS ST MARYS
 967 Windfall Road
 St Marys, Pennsylvania 15857-3397 USA
 Tel +1 (814) 834 9140
 Fax +1 (814) 781 7969
 Email: sales-pa@thermometrics.com

THERMOMETRICS KOREA
 #302 3rd floor Bethel Bldg,
 324-1 Yangjae-dong, Seocho-Ku, Seoul, Korea
 Tel +82 (0)2 5765232, 5233
 Fax +82 (0)2 576 5234
 Email: thmkorea@bora.dacom.co.kr